



4.4 Montaje con relés electrónicos de sobrecarga

Modelo de contactor	Modelo	Corriente térmica (A)	Regulaciones relé (A)	Fusible recomendado
NC1-09	 NRE8-25	1.2	0.6~1.2	RT36-4 (NT00-4)
		2.4	1.2~2.4	RT36-6 (NT00-6)
		4	2~4	RT36-10 (NT00-10)
		8	4~8	RT36-16 (NT00-16)
		10	5~10	RT36-20 (NT00-20)
		12	7~12	RT36-25 (NT00-25)
NC1-18	NRE8-25	20	10~20	RT36-40 (NT00-40)
NC1-25		25	20~25	RT36-50 (NT00-50)
NC1-32		32	22~32	RT36-80 (NT00-80)
NC1-40		 NRE8-40	4	2~4
	8		4~8	RT36-16 (NT00-16)
	10		5~10	RT36-20 (NT00-20)
	20		10~20	RT36-40 (NT00-40)
	40		20~40	RT36-80 (NT00-80)
NC1-40	 NRE8-100	65	30~65	RT36-160 (NT00-160)
NC1-50				
NC1-65				
NC1-80				
NC1-95				

5. Características técnicas

5.1 Conexiones

Modelo	Secciones de cable (Cu)				Tornillo	Par de apriete (N · m)
	Terminales	Cable flexible con terminal prensado (mm ²)	Cable flexible sin terminal prensado (mm ²)	Cable rígido (mm ²)		
NC1-09	1~2	2.5	4	4	M3.5	0.8
NC1-12	1~2	2.5	4	4	M3.5	0.8
NC1-18	1~2	4	6	6	M3.5	0.8
NC1-25	1	4	10	6	M4	1.2
	2	4	6	6	M4	1.2
NC1-32	1	4	10	6	M4	1.2
	2	4	6	6	M4	1.2
NC1-40	1	10	16	10	M4	1.2
	2	10	10	10	M8	3.5
NC1-50	1	16	25	25	M8	3.5
	2	16	16	-	M8	3.5
NC1-65	1	16	25	25	M8	3.5
	2	16	16	-	M8	3.5
NC1-80	1	50	50	50	M8	3.5
	2	25	35	-	M10	4.0
NC1-95	1	50	50	50	M10	4.0
	2	25	35	-	M10	4.0

5.2 Curvas

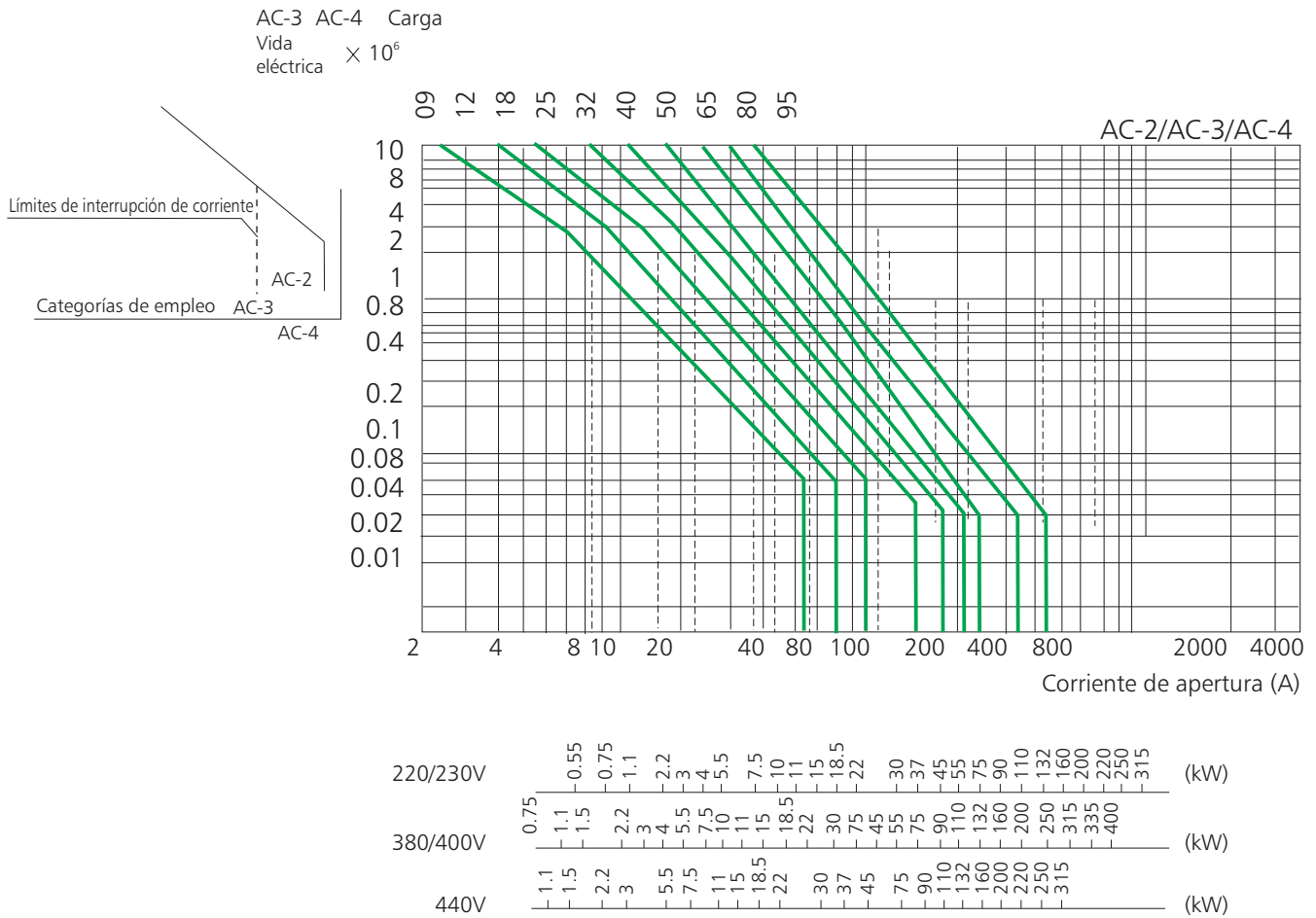

6. Dimensiones generales y de montaje (mm)

NC1-09~32

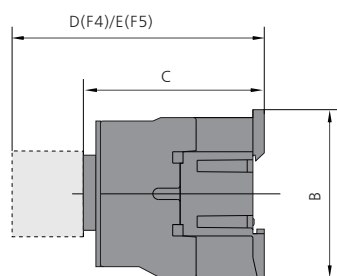
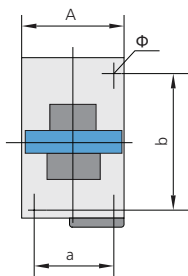

NC1-40~95

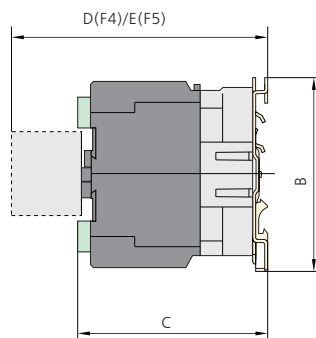
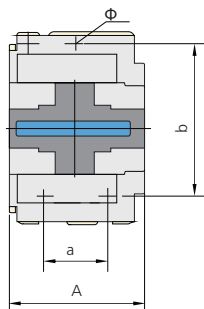
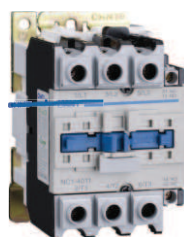

NC1-09Z~32Z

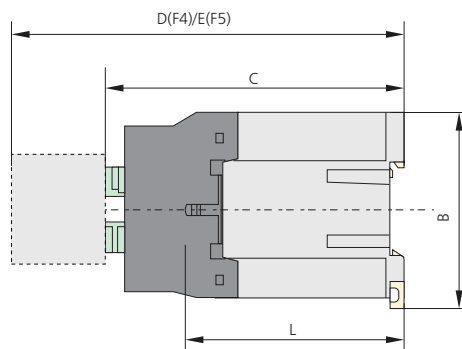
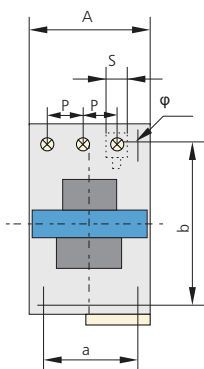

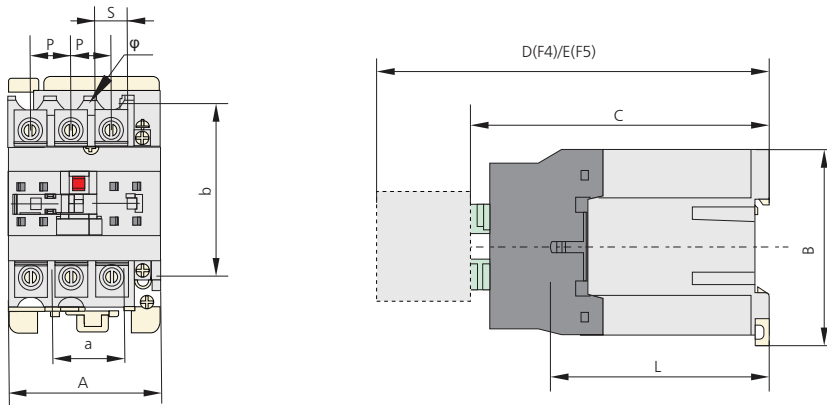

Modelo	A máx	B máx	C máx	D máx	E máx	a	b	Φ	L	P	S
NC1-09(Z)~12(Z)	47	76	82(116)	120.5(154.5)	140.5(174.5)	34/35	50/60	4.5	60(95)	10.5	8.6
NC1-18(Z)	47	76	87(122)	125.5(160.5)	145.5(180.5)	34/35	50/60	4.5	61(96)	11.3	10.4
NC1-25(Z)	57	86	95(131)	133.5(169.5)	153.5(189.5)	40	48	4.5	70(107)	13.2	11.7
NC1-32(Z)	57	86	100(138)	138.5(176.5)	158.5(196.5)	40	48	4.5	71.6(120)	14.5	13
NC1-4011(Z)~6511(Z)	77	129	116(173)	154.5(211.5)	174.5(231.5)	40	100/110	6.5	78(135)	20	8.6
NC1-4004/4008(Z)~6504/6508(Z)	84	129	116(173)	154.5(211.5)	174.5(231.5)	40	100/110	6.5	78(135)	20	8.6
NC1-8011(Z)~9511(Z)	87	129	127(188)	165.5(226.5)	185.5(246.5)	40	100/110	6.5	83(140)	23.5	12
NC1-8004/8008(Z)~9504/9508(Z)	96	129	127(183)	160.5(221.5)	180.5(241.5)	40	100/110	6.5	83(140)	23.5	12

Notas:

1. L: en circuito principal, distancia entre los terminales y la base;
2. P: en circuito principal, distancia entre dos fases;
3. S: en circuito principal, anchura de la pletina del terminal.